



PUMP ACTION SHOTGUN INSTRUCTION MANUAL

**READ THE INSTRUCTIONS AND
WARNINGS IN THIS MANUAL CAREFULLY
BEFORE USING THIS FIREARM**

INTRODUCTION

Thank you for purchasing the BALIKLI shotgun. We are sure this gun will bring you years of hunting or shooting pleasure.

This manual provides important information for assembling and using your new gun. Please read your Owner's Manual carefully before handling the gun.

Follow safe gun handling procedure at all times. Get instructions from a competent firearms instructor before using the firearm.

If you have questions or concerns about the assembly or the operation of your gun, see your dealer, or a qualified gunsmith.

Keep this manual, and consult it as needed. If you sell or transfer your gun, make sure the manual stays with the gun.

This shotgun, which is produced with the latest possibilities of the contemporary technology, is reliable and practical about its aesthetics, its lightness, its operating system and its expertise in service.

OPERATION

This pump shotgun is manually operated. Once a shell has been fired, the locking lug in the bolt moves down, unlocking the gun. The forearm can then be moved to the rear and forward again, ejecting and loading a new shell into the chamber.

To open the bolt without firing the gun, depress the action bar lock, located just beside and forward of the trigger. This allows for opening the action without dry firing.

SAFETY RULES

1. NEVER POINT A FIREARM AT SOMETHING THAT IS NOT SAFE TO SHOOT. Never let the muzzle of a firearm point at any part of your body or at another person. This is especially important when loading or unloading the firearm. When you are shooting at a target, know what is behind it. If you miss your target or if the bullet penetrates the target, it is your responsibility to ensure that the shot does not cause unintended injury or damage.

2. ALWAYS TREAT A FIREARM AS IF IT WERE LOADED. Never assume that a firearm is unloaded. The only certain way to ensure that a firearm is empty is to open the chamber and visually examine the inside to see if a round is present. Removing the magazine will not guarantee that a firearm is unloaded or cannot fire. Shotguns and rifles can be checked by cycling or removing all rounds and by then opening the chamber so that a visual inspection of the chamber for any remaining rounds can be made.

3. STORE YOUR FIREARM SO THAT CHILDREN CANNOT GAIN ACCESS TO IT. It is your responsibility to insure that children under the age of 18 or other unauthorized person does not gain access to your firearm. To reduce the risk of accidents involving children, unload your firearm, lock it and store the ammunition in a separate locked location. Please note that devices intended to prevent accidents - for example, cable locks, chamber plugs, etc. - may not prevent use or misuse of your firearm by a determined person. Steel gun safes may be more appropriate to reduce the likelihood of intentional misuse of a firearm by an unauthorized child or person.

4. NEVER SHOOT AT WATER OR AT A HARD SURFACE. Shooting at the surface of water or at a rock or other hard surface increases the chance of ricochets or fragmentation of the bullet or shot, which can result in the projectile striking an unintended or peripheral target.

5. KNOW THE SAFETY FEATURES OF THE FIREARM YOU ARE USING, BUT REMEMBER: SAFETY DEVICES ARE NOT A SUBSTITUTE FOR SAFE HANDLING PROCEDURES. Never rely solely on a safety device to prevent an accident. It is imperative that you know and use the safety features of the particular firearm you are handling, but accidents can best be prevented by following the safe handling procedures described in these safety rules and elsewhere in the product manual. To further familiarize yourself with the proper use of this or other firearms, take a Firearms Safety Course taught by an expert in firearm use and safety procedures.

6. PROPERLY MAINTAIN YOUR FIREARM. Store and carry your firearm so that dirt or lint does not accumulate in the working parts. Clean and oil your firearm, following the instructions provided in this manual, after each use to prevent corrosion, damage to the barrel or accumulation of impurities which can prevent use of the gun in an emergency. Always check the barrel prior to loading to ensure that it is clean and free from obstructions. Firing against an obstruction can rupture the barrel and injure you or others nearby. In case you hear an unusual noise when shooting, stop firing immediately, engage the manual safety and unload the firearm. Make sure the chamber is free from any obstruction inside the barrel due to defective or improper ammunition.

7. USE PROPER AMMUNITION. Only use factory-loaded, new ammunition manufactured to industry specifications: CIP (Europe and elsewhere), SAAMI (U.S.A.). Be certain that each round you use is in the proper caliber or gauge and type for the particular firearm. The caliber or gauge of the firearm is clearly marked on the barrels of shotguns. The use of reloaded or remanufactured ammunition can increase the likelihood of excessive cartridge pressures, case-head ruptures or other defects in the ammunition that can cause damage to your firearm and injury to yourself or others nearby.

8. ALWAYS WEAR PROTECTIVE GLASSES AND EARPLUGS WHEN

SHOOTING. The chance that gas, gunpowder or metal fragments will blow back and injure a shooter who is firing a gun is rare, but the injury that can be sustained in such circumstances is severe, including the possible loss of eyesight. A shooter must always wear impact resistant shooting glasses when firing any firearm. Earplugs help reduce the chance of hearing damage from shooting.

9. NEVER CLIMB A TREE, FENCE OR OBSTRUCTION WITH A LOADED

FIREARM. Open and empty the chamber of your firearm before climbing or descending a tree or before climbing a fence or jumping over a ditch or obstruction. Never pull or push a loaded firearm toward yourself or another person.

10. AVOID ALCOHOLIC BEVERAGES OR JUDGMENT OR REFLEX

IMPAIRING MEDICATION WHEN SHOOTING. Do not drink and shoot. If you take medication that can impair motor reactions or judgment, do not handle a firearm while you are under the influence of the medication.

11. NEVER TRANSPORT A LOADED FIREARM. Unload a firearm before putting it in a vehicle. Hunters and target shooters should load their firearm only at their destination. If you carry a firearm for self-protection, leaving the chamber unloaded can reduce the chance of accidental discharge.

12. LEAD WARNING. Discharging firearms in poorly ventilated areas, cleaning firearms, or handling ammunition may result in exposure to lead and other substances known to cause birth defects, reproductive harm, and other serious physical injury. Have adequate ventilation at all times. Wash hands thoroughly after exposure.

AMMUNITION

USE ONLY SUITABLE AMMUNITION

This pump action shotgun is chambered for 3 inch magnum shells. It is designed to be used with factory-loaded shells between 2 ¾ " and 3" in length. For 12 Gauge use the cartridges between 28 gr. (1 oz.) and 52 gr. (1 ⅞ oz.)

Use of re-loaded ammunition voids the factory warranty.

WARNING: Do not use 3 ½ inch shells in this shotgun.

WARNING: If your pump shotgun designed with choke system, never shoot slugs with a full choke. Use cylinder choke (5) and improved cylinder choke (4), which are marked with five cuts and four cuts.

WARNING: Never use cartridges with a case longer than the chamber, as this would have serious consequences for both the gun and the shooter.

WARNING: Never shoot steel shot with a full choke. Use only modified, improved cylinder or skeet choke tubes, marked three, four and five notches respectively.

ASSEMBLY

1. Remove the magazine cap.
2. Press upward on the action bar lock. Pull the forearm approximately halfway rearward.
3. Hold the barrel ahead of the barrel guide ring (See picture 1).

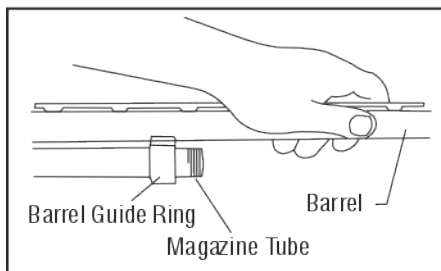

Picture 1

4. Slide the barrel guide ring over the magazine tube. Clean the barrel following the maintenance instructions on Page 11.
5. Press upward on the action bar lock.
6. Align the ejector on the inside of the barrel with the slot in the bolt.
7. Carefully set the barrel into the receiver. **DO NOT FORCE IT!**
8. Replace the magazine cap. Tighten.

DISASSEMBLY

1. Make sure the gun is unloaded!
2. Point firearm in a safe direction.
3. Push up on the action bar lock.
4. Slide forearm forward halfway.
5. Unscrew and remove the magazine cap.
6. Pull the barrel carefully out of the receiver.
7. Push the carrier forward.
8. Press and hold the action bar lock.
9. Slide the forearm forward and off the magazine tube.

LOADING

LOADING YOUR SHOTGUN ONE SHELL ONLY

1. Put safety in the "ON" position.
2. Point the gun in a safe direction.

3. Push up on the action bar lock.
4. Pull the forearm completely to the rear and carefully hold it for the return spring models.
5. Put one shell through the ejection port, making sure it is the correct gauge and length. (See picture 2)
6. Push the forearm forward and close the action.

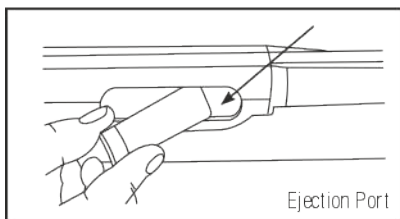

Picture 2

FULLY LOADING YOUR SHOTGUN

1. Put safety in the "ON" position.
2. Point the gun in a safe direction.
3. Push up on the action bar lock.
4. Pull the forearm completely to the rear and carefully hold it for the return spring models.
5. Put one shell through the ejection port, making sure it is the correct gauge and length. (See picture 2).
6. Push the forearm forward and close the action.
7. Push a shell upward against the bottom of the carrier. (See picture 3)
8. Push shells, one at a time, fully forward into the magazine tube.

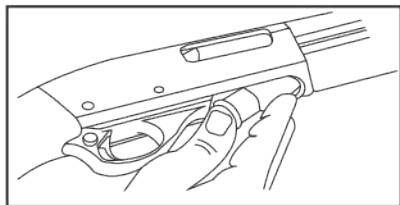

Picture 3

NOTE: For the models with return spring in the forend, you do not need to push the forearm to close the action. This will be done automatically by the help of the spring. The spring will close the action at a very fast rate. Use caution and watch out for your fingers and loose clothing.

SAFETY SWITCH OR BUTTON

The safety is designed to stop the trigger mechanism. **DON'T RELY ON YOUR GUN'S SAFETY, TREAT EVERY GUN AS IF IT WERE LOADED AND READY TO FIRE.** The safety on any gun is a mechanical device, and it is not intended as a substitute for common sense or safe gun handling. Always keep the muzzle pointed in a safe direction.

The safety is located behind the trigger, and provides protection against accidental or unintentional discharge under normal usage when properly used.

To engage the safety, push the button so that it protrudes from the right side of the gun and the **RED BAND MARKING CAN NOT BE SEEN.** The safety should always be in the "ON" or "SAFE" position until you intend to fire the gun (See picture 4).

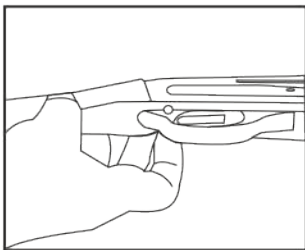

Picture 4

When you are ready to fire the gun, press the safety button to the "OFF" position so that the safety protrudes from the left side of the gun and the **RED BAND MARKING IS SHOWING.**

WARNING The gun will fire when the trigger is pulled intentionally or accidentally when the **RED BAND MARKING IS SHOWING.**

REMOVING AND REINSTALLING CHOKE TUBES





(IF YOUR SHOTGUN INCLUDES CHOKE TUBES)

Unload the gun and put the safety in the "ON" position. Remove a choke tube by inserting the choke key, and turning it counter clockwise.

After cleaning and lubricating, a choke tube may be reinstalled by starting the threads by hand, then tightening the choke tube with the choke key.

After each shooting session, the choke should be removed, cleaned, lubricated and reinstalled to prevent corrosion. Consult the choke value chart for suggested usage.

CHOKE VALUES FOR PUMP ACTION SHOTGUNS

| CHOKE VALUE | SYMBOL | NUMBER OF NOTCHES |
|---------------------------|---|-------------------|
| * FULL |  | 1 |
| ** IMPROVED MODIFIED |  | 2 |
| *** MODIFIED |  | 3 |
| **** IMPROVED CYLINDER |  | 4 |
| ***** SKEET |  | 5 |

Do not use choke values FULL, IMPROVED MODIFIED, and MODIFIED with slugs, single bullets or single projectiles.

Do not use choke value FULL or IMPROVED MODIFIED with steel shot.

MAINTENANCE

Proper maintenance is important to assure the best functioning of the gun, and the safety of the shooter.

Before using the shotgun make sure the barrel is clean and free of any grease or obstruction.

After each shooting session, dismantle the barrel, the barrel choke and the bolt for cleaning and lubrication, reinstall them as instructed.

After every shooting session, clean the magazine tube, the barrel ring and the gas ports.

Periodically during a shooting session, check the tightness of the magazine cap.

CLEANING AND LUBRICATION

WARNING: Before cleaning or lubricating the shotgun, make sure it is unloaded and the safety “ON”.

Materials and equipment necessary for cleaning and lubrication;

- Cleaning rod
- Cotton bore patches
- Brass bore brush
- Powder solvent
- Small soft brush
- Good quality shotgun oil

After use, to remove any powder and lead residue in the bore, scrub the barrel and chamber using the bore brush with powder solvent. Then swab the bore and the chamber with shotgun oiled cotton patches to protect from rust and corrosion.

After a high number of shots (about 500 shots), disassemble the bolt assembly and clean it with a soft brush and shotgun oil. Then dry it carefully with a soft cloth and oil the parts lightly.

Clean the outside of the magazine tube with a shotgun oiled soft cloth and then dry it with a soft cloth and oil the parts lightly.

Any powder on the chamber, barrel, etc. can be cleaned with a brush and powder solvent.

All external surfaces should be wiped down with light coat of rust preventative.

Avoid using too much solvent for bore cleaning, since prolonged contact may damage the finish of the shotgun. Make sure to wipe away all the excess solvent and lubricant.

STORAGE

Clean thoroughly and oil your gun before storage. Store the gun in a case to prevent scratches and dents. Store your firearm in a dry place to prevent corrosion.

Store the gun away from children and in a place where it cannot be obtained by those unauthorized to use it. Always store gun unloaded and separately from any ammunition.

HAZARDOUS MATERIAL WARNING

Discharging firearms in poorly ventilated areas, cleaning firearms, or handling ammunition, may result in exposure to lead and other substances known to cause birth defects, reproductive harm, and other serious injury. Have adequate ventilation at all times. Wash hands thoroughly after exposure.

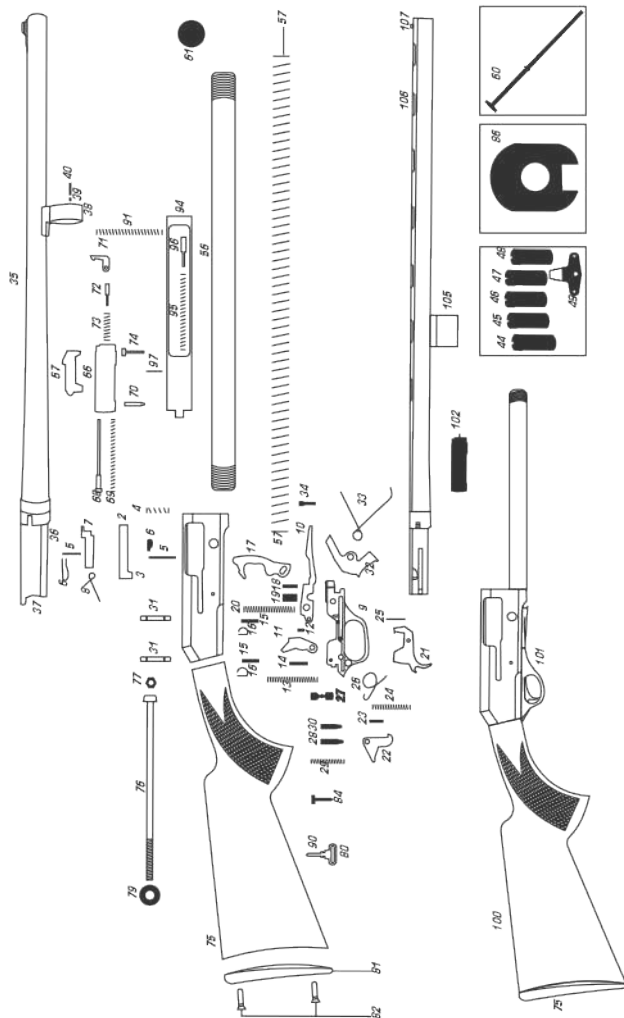

GENERAL ASSEMBLY

| <u>NO</u> | <u>PART NAME</u> | <u>NO</u> | <u>PART NAME</u> |
|------------------|---|--------------------|-------------------------|
| 1 | Receiver | 38 | Pump ring |
| 2 | Bolt release latch | 39 | Pump ring ball |
| 3 | Magazine extractor handle rivet | 40 | Pump ring spring |
| 5 | Magazine extractor pin | 44, 45, 46, 47, 48 | Mobile chokes |
| 7 | Magazine handle bolt | 49 | Mobile choke key |
| 8 | Magazine handle spring | 56 | Magazine tube |
| 9 | Trigger guard | 57 | Magazine spring |
| 10 | Carrier | 59 | Magazine follower |
| 11 | Carrier latch | 60 | Magazine plug |
| 12 | Carrier latch handle rivet | 61 | Magazine cap |
| 13 | Carrier latch retainer cartridge spring | 62 | Return spring |
| 14 | Carrier latch retainer cartridge | 66 | Breech bolt |
| 15 | Carrier cartridge | 67 | Locking block |
| 16 | Carrier cartridge segment | 68 | Firing pin |
| 17 | Hammer | 69 | Firing pin spring |
| 18 | Hammer retainer pin | 70 | Firing pin retainer |
| 19 | Hammer release cartridge | 71 | Extractor |
| 20 | Hammer retainer spring | 73 | Extractor spring bolt |
| 21 | Trigger | 74 | Extractor retainer pin |
| 22 | Inner safety | 75 | Stock |
| 23 | Inner safety press cartridge | 76 | Stock screw |
| 24 | Inner safety trigger spring | 80 | Stock swivel |
| 25 | Inner safety trigger pin | 81 | Butt plate |
| 26 | Trigger press spring | 82 | Butt plate screw |
| 27 | Safety | 86 | Shim kit |
| 28 | Safety retainer cartridge | 91 | Forend pin |
| 29 | Safety spring | 94 | Action bar |
| 30 | Safety release pin | 95 | Bolt extractor |
| 31 | Trigger set pin | 96 | Bolt extractor pin |
| 32 | Bolt lock | 97 | Operating pin |
| 33 | Bolt lock spring | 100 | Stock with butt plate |
| 34 | Bolt lock screw | 101 | Trigger set |
| 35 | Barrel | 102 | Breech bolt |
| 36 | Bearing bolt | 105 | Barrel with rib |
| 37 | Cap pin | 106 | Rib |
| | | 107 | Front sight |

WARRANTY DEED

This product is covered by a 2-year guarantee by BALIKLI ARMS against faulty workmanship and manufacturing defects and BALIKLI ARMS agrees to supply free replacement parts (wood not included) for defected parts from date of purchase.

DISCLAIMER OF THE WARRANTY

- * Occurrence of damages due to firing with hand-filled or refilled cartridges
- * Occurrence of damages due to firing in case of blockage in the barrel
- * Occurrence of damages due to the lack of regular and necessary maintenance
- * Repairs and replacements made by unauthorized persons on guns are make warranty invalid.

Please note that certificates that are not sealed by the vendor or that are incomplete are invalid. By purchasing the product, the user acknowledges and agrees the foregoing.

- To be lled by the vendor -

Model /Calibre :
Serial No. :
Buyer's Name and Surname:
Sales Invoice No. :
Date of Sale :

[Vendor's seal and signature]



Üzümlü Mah. Köküstü Küme Evleri No. 12



Tel. +90 332 524 6 524 - 524 68 03



www.baliklisilah.com



Instagram

[instagram.com/balikli_silah](https://www.instagram.com/balikli_silah)

BEYŞEHİR / KONYA

Fax. +90 332 524 68 01



info@baliklisilah.com



[facebook.com/Balikli Silah](https://www.facebook.com/BalikliSilah)

Contact +90 530 099 32 93